

EXTERNAL WALL TYPES	
WT-01	200MM PRECAST CONCRETE PANEL SELECT FINISH
WT-02	185MM THICK WALL WITH 150MM PRECAST CONCRETE PANEL WITH SELECT FINISH WITH 35MM TOPHAT AND 10MM PLASTERBOARD LINING TO APARTMENT SIDE (WATER RESISTANT PLASTERBOARD TO WET AREAS)
WT-03	235MM THICK WALL WITH 200MM PRECAST CONCRETE PANEL WITH SELECT FINISH TO EXTERNAL PANELS WITH 35MM TOPHAT AND 10MM PLASTERBOARD LINING TO INTERNAL (WATER RESISTANT PLASTERBOARD TO WET AREAS)
WT-04	240MM THICK WALL WITH 150MM PRECAST CONCRETE PANEL WITH SELECT FINISH TO EXTERNAL PANELS WITH 90MM STEEL STUD WALL AND 10MM PLASTERBOARD LINING TO INTERNAL (WATER RESISTANT PLASTERBOARD TO WET AREAS)
WT-05	285MM THICK WALL WITH 250MM PRECAST CONCRETE PANEL WITH SELECT FINISH TO EXTERNAL PANELS WITH 35MM TOPHAT AND 10MM PLASTERBOARD LINING TO INTERNAL (WATER RESISTANT PLASTERBOARD TO WET AREAS)
WT-06	90MM THICK WALL WITH DECO CLAD VERTICAL CLADDING 200MM SHADOWLINE BOARD WITH SNOW GUM FINISH OVER SARKING INSTALLED AS PER MANUFACTURES SPECIFICATION ON 90MM STEEL STUD WITH 10MM PLASTERBOARD LINING TO INTERNAL SIDE (WATER RESISTANT PLASTERBOARD TO WET AREAS)
WT-07	155MM THICK WALL WITH DECO CLAD VERTICAL CLADDING 200MM SHADOWLINE BOARD WITH SNOW GUM FINISH OVER SARKING INSTALLED AS PER MANUFACTURES SPECIFICATION ON 35MM TOPHATS IMBEDDED INTO 230MM PRECAST PANEL
WT-08	155MM THICK WALL WITH ALUCLAD 30MM CASSET SYSTEM INSTALLED AS PER MANUFACTURES SPECIFICATIONS ON 35MM TOPHATS FIXED TO 90MM STEEL STUD WALL
WT-09	220MM THICK WALL WITH MAXLINE 340 CLADDING WITH CONCEALED FIXING CLIP OVER SARKING AS PER MANUFACTURES SPECIFICATIONS ON 35MM TOPHATS OVER 150MM THICK PRECAST CONCRETE PANEL WITH SELECT FINISH WITH 35MM TOPHAT AND 10MM PLASTERBOARD LINING TO INTERNAL SIDE (WATER RESISTANT PLASTERBOARD TO WET AREAS)
WT-10	75MM THICK ALUMINUM SCREEN WITH DECO SLATE INFILL TO SELECT FINISH
WT-11	200MM PRECAST CONCRETE PANEL SELECT FINISH (WHERE BELOW GROUND LEVEL) APPROVED WATERPROOF MEMBRANE AS PER ENGINEERS DETAILS

INTERNAL WALL TYPES	
WT-20	90MM THICK BIN STORE WALL WITH 90MM STEEL FRAMING WITH DECO WOOD SLATES WITH SELECT FINISH
WT-21	150MM THICK WALL WITH 150MM PRECAST CONCRETE PANEL WITH SELECT FINISH
WT-22	150MM THICK WALL WITH 150MM PRECAST CONCRETE PANEL WITH SELECT FINISH WITH DIRECT STICK 10MM PLASTERBOARD TO APARTMENT SIDE (WATER RESISTANT PLASTERBOARD TO WET AREAS)
WT-23	185MM THICK WALL WITH 150MM PRECAST CONCRETE PANEL WITH DIRECT STICK PLASTERBOARD LINING (WATER RESISTANT PLASTERBOARD TO WET AREAS) TO ONE SIDE AND 35MM TOPHAT AND 10MM PLASTERBOARD LINING TO THE OTHER SIDE (WATER RESISTANT PLASTERBOARD TO WET AREAS)
WT-24	275MM THICK WALL WITH 150MM PRECAST CONCRETE PANEL WITH 35MM TOPHAT AND 10MM PLASTERBOARD LINING (WATER RESISTANT PLASTERBOARD TO WET AREAS) TO ONE SIDE AND 90MM STEEL FRAMING AND 10MM PLASTERBOARD LINING TO THE OTHER SIDE (WATER RESISTANT PLASTERBOARD TO WET AREAS)
WT-25	220MM THICK WALL WITH 150MM PRECAST CONCRETE PANEL WITH 35MM TOPHAT AND 10MM PLASTERBOARD LINING TO BOTH SIDES (WATER RESISTANT PLASTERBOARD TO WET AREAS)
WT-26	90MM THICK INTERNAL WALL WITH 90MM STEEL STUD WITH 10MM PLASTERBOARD TO BOTH SIDES (WATER RESISTANT PLASTERBOARD TO WET AREAS)

FLOOR FINISHES	
CONC-TR	OFF FORM CONCRETE WITH TROWELED FINISH WITH FALL TO SUMP
CONC-TL	OFF FORM CONCRETE WITH TILE FINISH WITH FALL AWAY FROM BUILDING TO DRAIN - REFER SCHEDULE FOR SELECTION
CONC-TLW	OFF FORM CONCRETE WITH TILE FINISH OVER WATERPROOF MEMBRANE - REFER SCHEDULE FOR SELECTION WITH FALL TO TRAP
CONC-CP	OFF FORM CONCRETE WITH UNDERLAY AND CARPET FINISH - REFER SCHEDULE FOR SELECTION
DELTA-TL	DELTA FLOOR PLANKS WITH TOPING SLAB WITH TILE FINISH - REFER SCHEDULE FOR SELECTION
DELTA-TLW	DELTA FLOOR PLANKS WITH TILE FINISH OVER WATERPROOF MEMBRANE WITH FALL TO TRAP - REFER SCHEDULE FOR SELECTION
DELTA-CP	DELTA FLOOR PLANKS WITH TOPING SLAB WITH UNDERLAY AND CARPET FINISH - REFER SCHEDULE FOR SELECTION
DELTA-CO	DELTA FLOOR PLANKS WITH TOPING SLAB WITH CONCRETE FINISH WITH FALL TO TRAP

**BELAY PURLIN ANCHOR
POINTS TO UNDERSIDE OF
ROOF STRUCTURE**

Legend

Description

RIS AP Purlin

Note: All and any dimension shown, including the location of any safety systems (anchor points, ladder brackets and other items supplied by RIS), at the time of this quote are indicative locations and representation of anchors only. Roof materials and substructures must be confirmed. A RIS site manager will need to confirm all details, mentioned above and in the quote prior, the starting of any work.

This design complies with the Australian Standards and the National Code of Practice.

RIS Drawing is copyright © all rights reserved.

Drawn: NB
Dated: 08 Jan 2019
Dated Rev:

- GENERAL NOTES:**
- 1) FIXTURE LOCATION SHOWN INDICATIVE ONLY. EXACT POSITION TO BE CONFIRMED ON SITE AND CO-ORDINATED WITH NOMINATED FIXTURE SPECIFICATIONS.
 - 2) THIS PLAN TO BE READ AND CO-ORDINATED WITH THE ENGINEER'S FOOTING AND SLAB LAYOUTS. ANY DISCREPANCIES TO BE REPORTED TO THE DESIGNER IMMEDIATELY.
- PLEASE NOTE: ALL KITCHEN & WET AREA LAYOUTS SHOWN ON THESE PLANS ARE INDICATIVE ONLY. REFER TO SELECTED JOINERY MANUFACTURER'S PLANS FOR CORRECT LAYOUTS AND PLUMBING POSITIONS AND CO-ORDINATE ACCORDINGLY.
- * REMOVABLE DOOR HINGES FITTED IN ACCORDANCE WITH S.A. HOUSING CODE APPENDIX D10.1
- SC STEEL COLUMN
REFER TO ENGINEER'S DRAWINGS FOR SIZE
- P SELECTED CISTERN
- LN LINEN
- VAN SELECTED VANITY
- MC MIRROR CABINET
- OHC OVERHEAD CUPBOARDS
- TR SELECTED LAUNDRY TROUGH
- WM SELECTED WASHING MACHINE
- UBO UNDER BENCH OVEN
- DW SELECTED DISHWASHER
- FR/FZ FRIDGE/FREEZER
- RHO SELECTED RANGEHOOD OVER
- HP SELECT HOT PLATE
- SINK SELECT SS SINK
- PTRY PANTRY
- SHR SELECT SHOWER ALCOVE
- HR HAND RAIL, AS PER SELECTION
- FT FLOOR TRAP TO ENG. DETAILS
- DW DRAWER WITH SHARK NOSE
- SD STRIP DRAIN TO ENG. DETAILS
- DR SELECTED DRYER
- BH PLASTERBOARD BULKHEAD
- MT SELECTED MIXER TAP
- SR SELECT SHOWER ROSE
- TRH SELECT TOILET ROLL HOLDER
- TH SELECT TOWEL HOOK
- NTR SELECT HAND TOWEL RAIL

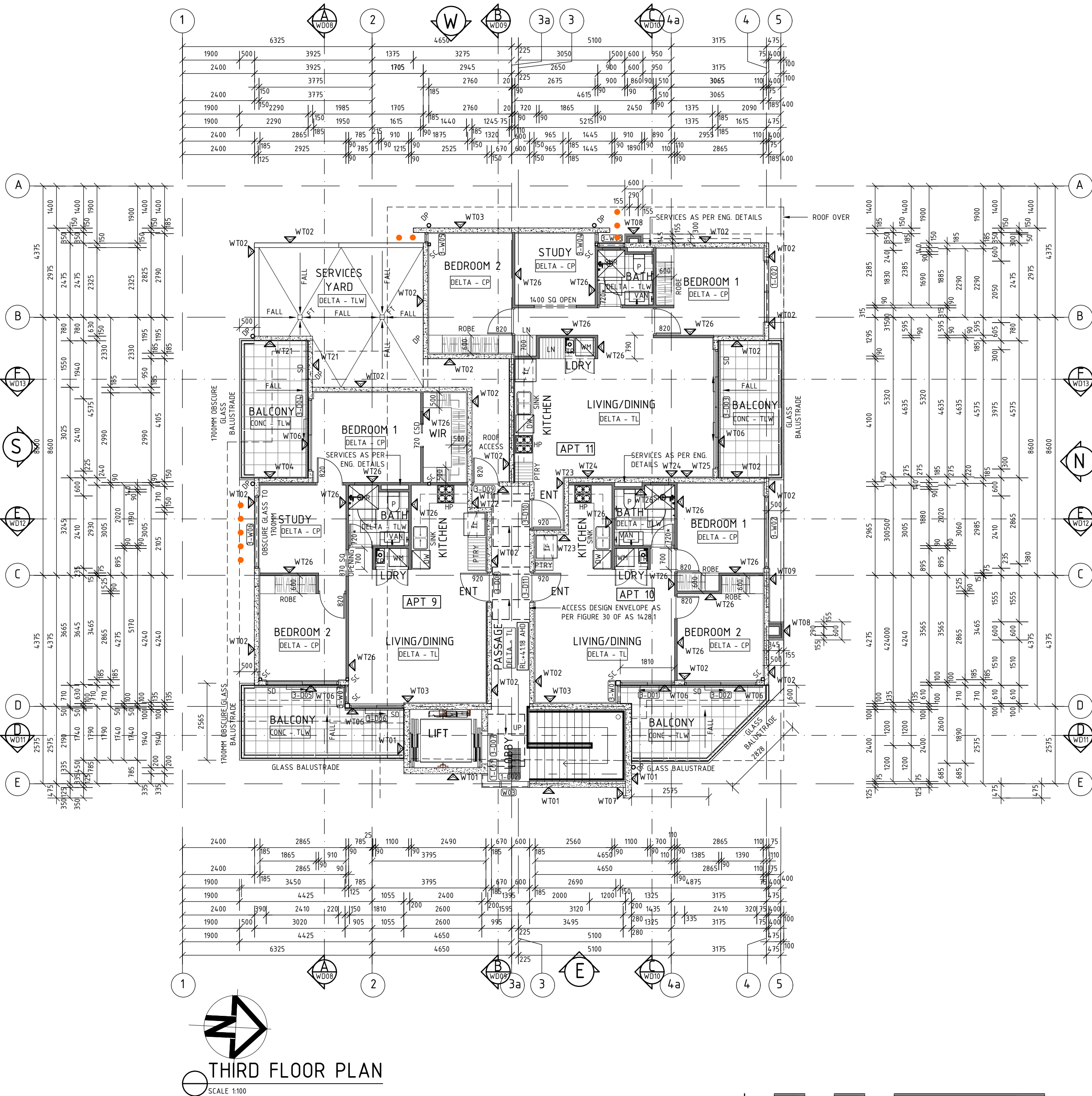
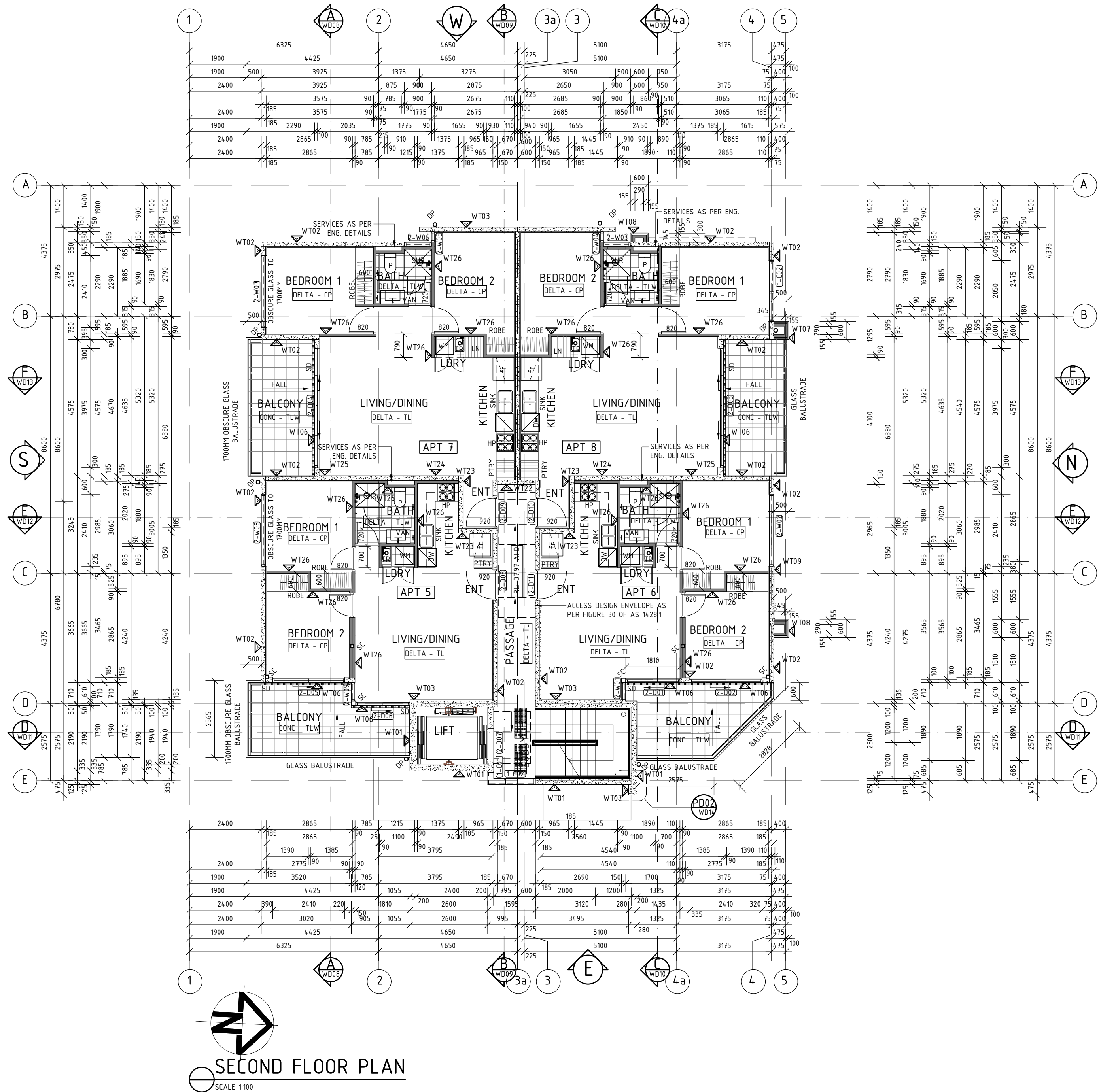

PRELIMINARY
DATED 13/08/18

REVISIONS			
DATE	REV	DESCRIPTION	BY
21/09/18	B	AS PER ENG.	BF

DESIGN OUTSIDE THE SQUARE
35 Portrush Road, Payneham
SA 5070
P. 08 7078 4070
E. hello@thinkdesignstudio.com.au
W. www.thinkdesignstudio.com.au

PROPOSED RESIDENTIAL DEVELOPMENT

CLIENT NAME:
NIATRON 10 PTY LTD

ADDRESS:
419 REGENCY ROAD

SUBURB:
PROSPECT

COUNCIL ZONE:
CITY OF PROSPECT

DATE: 13/08/18	SHEET NO: WD 05 OF 19
PROJECT: 33 2016	TYPE: RESIDENTIAL
PAGE SIZE: A1	SCALE: 1:100 A/C B/F

DESIGNED BY: DRAWN BY:

ALL DIMENSIONS AND LEVELS TO BE CONFIRMED PRIOR TO COMMENCING ANY WORK.
FIXTURES/DETAILED: TAKE PREFERENCE OVER SCALE.
DISCREPANCY SHALL BE REPORTED TO THINK DESIGN STUDIO IMMEDIATELY.

© COPYRIGHT THINK DESIGN STUDIO 2018